



PLANTING NOTES
 1. REFER TO SHEET L300 FOR PLANT SCHEDULE, NOTES AND DETAILS.

CONSTRUCTION NOTES:
 ① EXPANSION JOINT, REFER TO WP PLANS
 ② DALTON STREET BELOW

LEGEND
 SODDED TURF
 OVERSEED AREA
 SHRUBS / PERENNIALS

PLANT MATERIAL INCLUDING SHRUBS, PERENNIALS, ORNAMENTAL GRASSES, AND ANNUALS SHALL BE FURNISHED AND INSTALLED BY THE OWNER.
 CONTRACTOR SHALL INSTALL ALL PLANTING SOIL, TURF AND MULCH. SCHEDULING OF THE INSTALLATION OF THE MULCH TO BE COORDINATED BETWEEN THE CONTRACTOR AND OWNER SO AS NOT TO DUPLICATE EFFORTS.

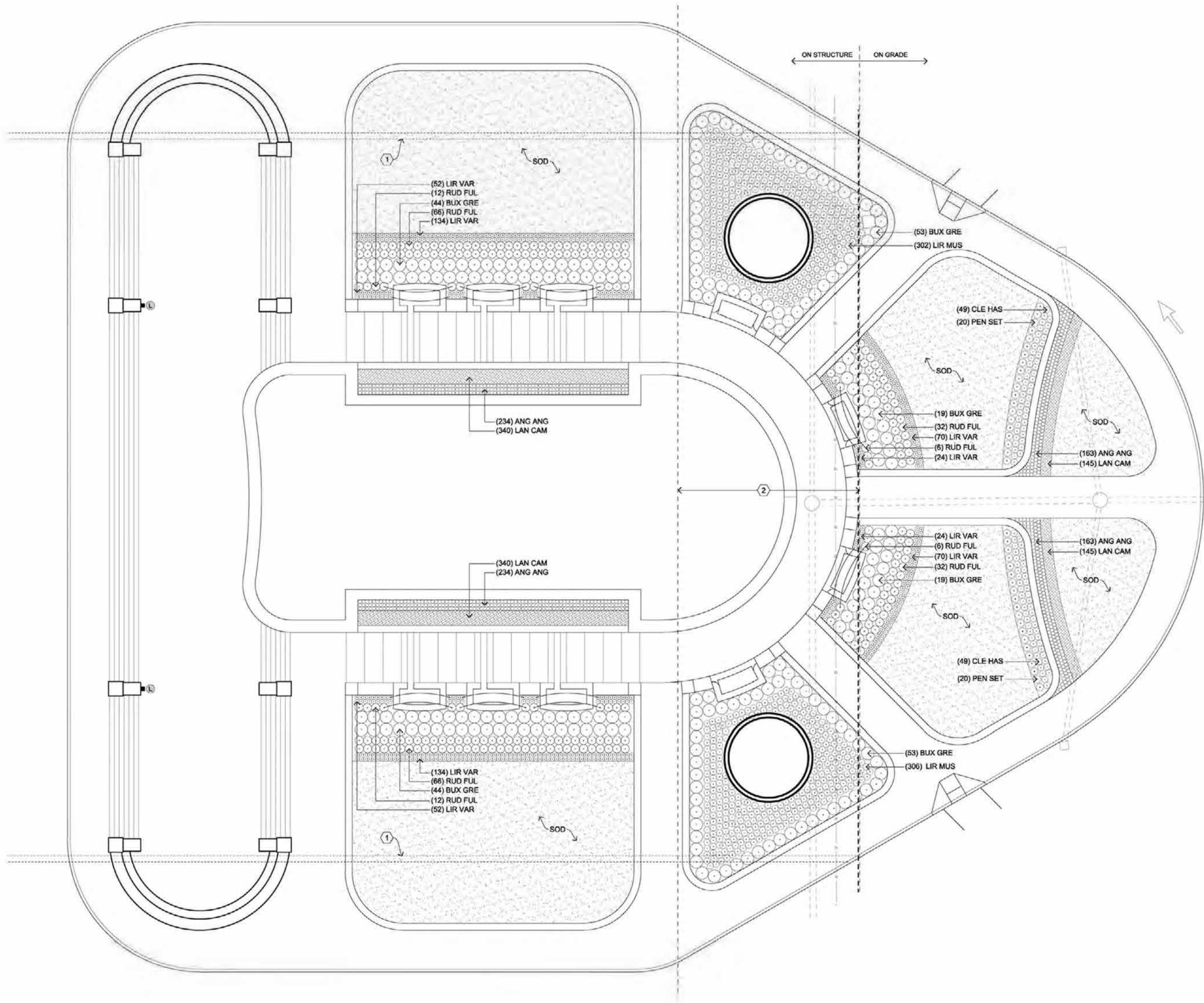

GBBN
 architects

Project Architect
 GBBN Architects Inc.
 332 East 8th Street
 Cincinnati, OH 45202
 T (513) 241-8700
 F (513) 241-8873
 http://www.gbbn.com

CINCINNATI UNION TERMINAL
 RENOVATION & RESTORATION
 1301 Western Ave., Cincinnati, OH 45203

UNION
 TERMINAL
 LLC

Construction Manager
 Turner Construction
 250 West Court St. Ste. 300
 Cincinnati, OH 45202
 (513) 721-4224

Preservation Architect
 John G. Walle Assoc. Architects
 384 Broadway
 Albany, NY 12207
 (518) 449-5440
 64 Fulton St. Ste. 402
 New York, NY 10038
 (212) 619-4881

Structural Engineer
 Silman
 32 Old Slip, 10th Floor
 New York, NY 10005
 (212) 620-7970

Structural Engineer
 TJP Limited Inc.
 100 East 8th St.
 Cincinnati, OH 45202
 (513) 241-3222

MEP Engineer
 Anip
 1120 Connecticut Ave. Ste. 1110
 Washington DC, 20036
 (202) 729-8220

MEP Engineer
 Heagy Engineering
 1400 West Dorothy Ln.
 Dayton, OH 45409
 (937) 224-0861

Civil Engineer
 Landscape Architect
 The Klingers Group
 6305 Centre Park Dr.
 West Chester, OH 45069
 (513) 779-7851

CONSTRUCTION
 DOCUMENTS
 PACKAGE E - EXTERIOR/SITE

No.	Date	Description
1	06/17/16	CMP - PKG. E
2	08/12/16	CONSTRUCTION DOCUMENTS - PKG. E

PLAZA LANDSCAPE
 PLAN

Job Number
 13513.01
 Drawn By
 KLEINGERS
 Scale
 1" = 10'-0"
 Date
 06/17/16



L301